



# FLARE 3.0

Coverage up  
to 3,000 ft<sup>2</sup>

Voice &  
4G LTE

All  
Carriers

Auto Gain  
Control

## SureCall Flare<sup>®</sup> 3.0

Improving Cell Service for Homes up to 3,000 sq. ft.

### Overview

The SureCall Flare 3.0 signal booster improves voice, text, and 4G LTE signals for all US cell carriers. Flare 3.0 takes the multi-award winning SureCall Flare model one step further to deliver even more cellular reliability to homes and small buildings in rural areas.

Flare 3.0 comes kitted with a Yagi-directional antenna and an average 9 dB increase in uplink power for the frequencies that are most commonly used in rural areas to cover up 3,000 square feet. Together, the increased uplink and upgraded Yagi antenna pack the Flare 3.0 with 8X more connecting power for homes and offices in the most challenging signal locations. As with the Flare, the Flare 3.0 has combined the booster and indoor antenna to streamline the system's design for easier installation and an attractive, low-profile appearance.

- Improves cell service for all US cell carriers
- Boosts voice, text and 4G LTE data signal
- Compatible with all cellular devices, including hotspots
- Extends coverage indoors up to 3,000 sq. ft.
- Supports multiple users simultaneously
- Backed by industry leading 3 year manufacturer's warranty

### Package Contents

The Flare 3.0 Kit (SC-Flare3US) includes: the Flare 3.0 booster with built-in indoor antenna, power supply, coax cable and outdoor Yagi antenna.

### Installation Example

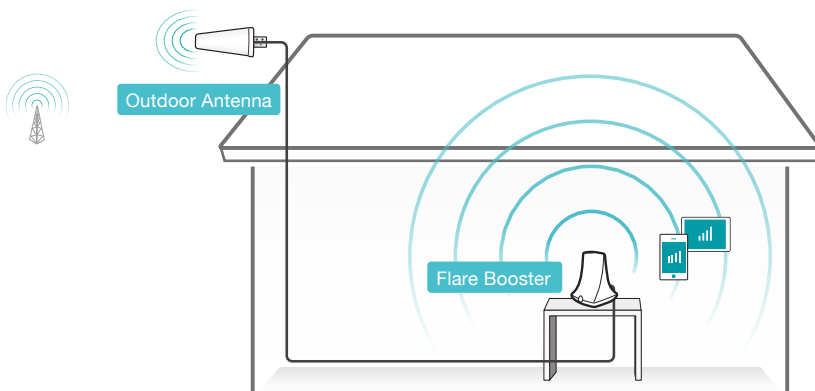

The SureCall Flare 3.0 signal booster



### Specifications

Uplink Frequency Ranges (MHz):	698-716 / 776-787 / 824-849 / 1710-1755 / 1850-1915
Downlink Frequency Ranges (MHz):	728-746 / 746-757 / 869-894 / 1930-1995 / 2110-2155
Max Gain:	72 dB
Impedance:	75Ω in / 50Ω out
Max Uplink Power:	26.0 dBm
Cable:	RG6 (50 ft.)
RF Connectors:	F Female
FCC ID / IC:	RSNFLARE-3 / 7784A-FLARE3

► Patent No. US 8,867,572 B1; US 9,100,839 B2